

## Dimensions and Flange specifications - 2500 Lbs

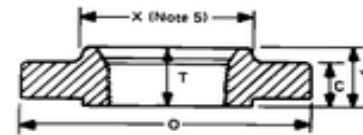

Threaded

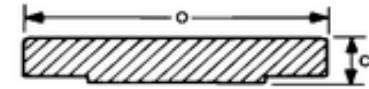

Blind

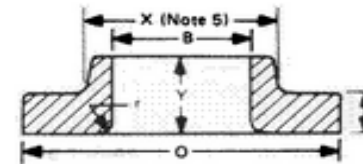

Lapped

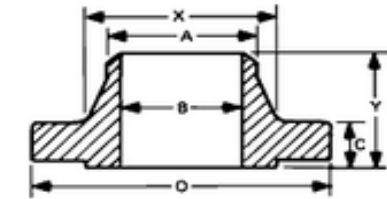

Welding Neck

Dimensions Class 2500 acc. to ASME / ANSI B16.5

Dimensions		Length through Hub							Bore				
Normal Pipe Size	Normal Pipe Size	Outside diameter of Flange	Thickness of Flange	Diameter of Hub	Hub diameter Beginning of Chamfer Welding Neck	Threaded	Lapped	Welding Neck	Thread Length Threaded Flange	Lapped	Welding Neck (Std.)	Corner Radius of Bore of Lapped Flange and Pipe	Counter bore Threaded Flange
mm	inch	O	Min. C	X	A	Y	Y	Y	Min. T	Min. B	B	r	Min. Q
15	1/2"	135	30,5	43	21,5	40	40	73	29	23	To be specified by purchaser	3	23,5
20	3/4"	140	32	51	26,5	43	43	79	32	28		3	29
25	1"	160	35	57	33,5	48	48	89	35	35		3	36
32	1-1/4"	185	38,5	73	42	52	52	95	38	43,5		5	44,5
40	1-1/2"	205	44,5	79	48,5	60	60	111	44	50		6	50,5
50	2"	235	51	95	60,5	70	70	127	51	62,5		8	63,5
65	2-1/2"	270	57,5	114	73	79	79	143	57	75,5		8	76
80	3"	305	67	133	89	92	92	168	63	91,5		10	92
100	4"	355	76,5	165	114,5	108	108	190	70	117		11	118

Dimensions			Length through Hub						Bore				
Normal Pipe Size	Normal Pipe Size	Outside diameter of Flange	Thickness of Flange	Diameter of Hub	Hub diameter Beginning of Chamfer of Welding Neck	Threaded	Lapped	Welding Neck	Thread Length Threaded Flange	Lapped	Welding Neck (Std.)	Corner Radius of Bore of Lapped Flange and Pipe	Counter bore Threaded Flange
mm	inch		Min.						Min.	Min.			Min.
		O	C	X	A	Y	Y	Y	T	B	B	r	Q
125	5"	420	92,5	203	141,5	130	130	229	76	144,5		11	145
150	6"	485	108	235	168,5	152	152	273	82	171,5		13	171
200	8"	550	127	305	219	178	178	318	95	222		13	222
250	10"	675	165,5	375	273	229	229	419	108	277,5		13	276
300	12"	760	184,5	441	324	254	254	464	121	328		13	329