

## Socket weld - ANSI B16.11



### Couplings - black

\*AN "X" combined with green marking: in stock

\* Red marking: 1 or 2 days

Forgede carbon steel fittings to ASTM A105

Certificates acc. To EN 10204/3.1

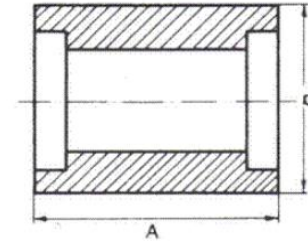

Norm.	3000 Lbs				Avaliable	Theor.	6000 Lbs				Avaliable	Theor
	Diam	A		B			A		B			
inch	mm	inch	mm	inch	in	Kg/ea	mm	inch	mm	inch	in	weight
					Stock						stock	Kg/ea
1/4"	25,5	1	21	5/6		0,055						
3/8"	25,5	1	25	1		0,062						
1/2"	28,5	1 1/8	31	1 2/9	X	0,110	28,5	1 1/8	33	1 1/3		0,14
3/4"	35,5	1 2/5	36	1 3/7	X	0,170	35,5	1 2/5	40	1 1/4		0,25
1"	39	1 1/2	45	1 7/9		0,270	39	1 1/2	50	2		0,36
1.1/4"	39	1 1/2	55	2 1/6		0,350						
1.1/2"	39	1 1/2	60	2 3/8	X	0,425	39	1 1/2	65	2 5/9		0,57
2"	51	2	75	3	X	0,715	51	2	82	3 1/4		1,2
2.1/2"	51	2		0		1,13						
3"	51	2	108	4 1/4		1,5						
4"	60	2 3/8	135	5 1/3		2,500						