

Screwed NPT - ANSI B16.11



Elbows 90° - Black/galvanised

*AN "X" combined with green marking: in stock

* Red marking: 1 or 2 days

Forgede carbon steel fittings to ASTM A 150

Certificates acc. to EN 10204/3.1

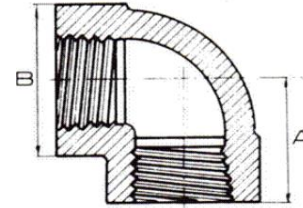

Norm.	3000 Lbs					delivery		theor. Weight	6000 Lbs					delivery		theor weight
	diam	A		B		progr	black		A	B		progr	black	Kg/ea		
inch	mm	inch	mm	inch	mm	Black	galv	Kg/ea	mm	inch	mm	inch	black	Kg/ea		
1/4"	25,4	1	26,5	1				0,170								
3/8"	28,5	1 1/8	34,0	1 1/3				0,284								
1/2"	33,5	1 1/3	36,5	1 4/9				0,593								
3/4"	38,0	1 1/2	46,5	1 5/6				0,624	44,5	1 3/4	56,5	2 2/9		1,19		
1"	44,5	1 3/4	56,5	2 2/9				1,130	51,0	2	62,5	2 1/2		1,58		
1.1/4"	51,0	2	62,5	2 1/2				1,250								
1.1/2"	60,5	2 3/8	76,0	3				1,530	63,5	2 1/2	92,0	3 5/8		3,40		
2"	63,5	2 1/2	92,0	3 5/8				2,470	82,5	3 1/4	110,0	4 1/3		6,19		
3"	95,5	3 3/4	112,0	4 4/5				6,550								
4"	114,5	4 1/2	152,0	6				13,800								