

End caps - DIN 2617



End Caps DIN 2617

* An "X" combined with green marking: in stock

* Red marking: 1 or 2 days

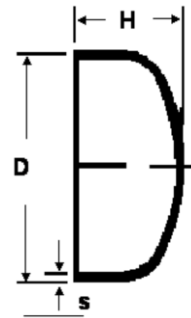

Outside diameter mm D	Wall thickness mm s1	Height mm	Weight kg	Available in stock
21,3	2,0	25,0	0,060	
26,9	2,3	32,0	0,070	
33,7	2,6	38,0	0,110	
	3,2		0,130	
42,4	2,6	38,0	0,130	
	3,6		0,170	
48,3	2,6	38,0	0,200	
	4,0		0,230	
60,3	2,9	38,0	0,280	
	4,5		0,320	
76,1	2,9	38,0	0,340	
	5,0		0,390	
88,9	3,2	51,0	0,530	
	5,6		0,700	
108,0	3,6	64,0	1,000	
114,3	3,6	64,0	1,000	
	6,3		1,500	
133,0	4,0	76,0	1,600	
139,7	4,0	76,0	1,700	
	6,3		2,500	
159,0	4,5	90,0	2,400	
168,3	4,5	89,0	2,650	
	7,1		3,550	
219,0	6,3	100,0	5,550	
	8,0		6,700	
273,0	6,3	127,0	8,800	
323,9	7,1	152,0	14,000	
355,6	8,0	165,0	16,500	
406,4	8,8	178,0	18,200	
508,0	11,0	229,0	38,000	