

End caps - DIN 28011



End caps DIN 28011

* An "X" combined with green marking: in stock

* Red marking: 1 or 2 days

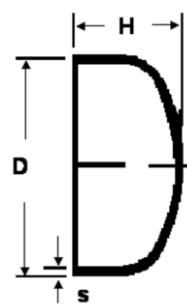

Outside diameter mm D	Wall thickness mm s	Radius mm	Weight kg	Available in stock
21,3	3,0	17,0	0,060	
26,9	3,0	17,0	0,060	
33,7	3,0	18,0	0,070	
38,0	3,0	20,0	0,080	
42,4	3,0	20,0	0,080	
48,3	3,0	22,0	0,110	
60,3	3,0	24,0	0,170	
70,0	3,0	26,0	0,210	
76,1	3,0	27,0	0,250	
88,9	3,0	28,0	0,320	
101,6	4,0	42,0	0,510	
108,0	4,0	43,0	0,610	
114,3	4,0	44,0	0,660	
133,0	4,0	48,0	0,840	
139,7	4,0	49,0	0,960	
159,0	5,0	53,0	1,400	
168,3	5,0	55,0	1,700	
197,3	5,0	60,0	2,100	
219,1	6,0	71,0	3,300	
244,5	6,0	76,0	4,000	
273,0	6,0	81,0	4,800	
323,9	7,0	91,0	7,600	
355,6	8,0	103,0	11,000	
406,4	8,0	113,0	14,100	
457,0	10,0	129,0	21,700	
508,0	10,0	137,0	26,300	
609,6	12,0	170,0	46,000	